

GENERAL INFORMATION	SPECIFICATIONS
CROSS-REFERENCE	PACKAGE SYSTEMS
<p>1C. 3" Non-Clog Submersible Explosion Proof Pumps</p>	
<p>PUMP SERIES:</p>	
<p>3XSE(.75HP, 1150RPM)</p>	
<p>3XSE(1.5 - 3HP, 1750RPM)</p>	

This page intentionally left blank

3" Horizontal Discharge XP - Submersible Non-Clog Pumps

*Previous Models		Current Models		
MODEL	P/N	MODEL	P/N	PAGE NO.
300L5	.75HP/115/1	3XSE716EA	087756	1 - 3
300L5	.75HP/200/1	3XSE706EA	087757	1 - 3
300L5	.75HP/230/1	3XSE726EA	087758	1 - 3
300L5	.75HP/200/3	3XSE766EA	087759	1 - 3
300L5	.75HP/230/3	3XSE736EA	087760	1 - 3
300L5	.75HP/460/3	3XSE746EA	087761	1 - 3
300L5	1.5HP/200/1	3XSE1504EA	087740	4 - 6
300L5	1.5HP/230/1	3XSE1524EA	087741	4 - 6
300L5	1.5HP/200/3	3XSE1564EA	087742	4 - 6
300L5	1.5HP/230/3	3XSE1534EA	087743	4 - 6
300L5	1.5HP/460/3	3XSE1544EA	087744	4 - 6
300L5	2.0HP/200/1	3XSE2004EA	087745	4 - 6
300L5	2.0HP/230/1	3XSE2024EA	087746	4 - 6
300L5	2.0HP/200/3	3XSE2064EA	087747	4 - 6
300L5	2.0HP/230/3	3XSE2034EA	087748	4 - 6
300L5	2.0HP/460/3	3XSE2044EA	087749	4 - 6
300L5	3.0HP/200/1	3XSE3004EA	087750	4 - 6
300L5	3.0HP/230/1	3XSE3024EA	087751	4 - 6
300L5	3.0HP/200/3	3XSE3064EA	087752	4 - 6
300L5	3.0HP/230/3	3XSE3034EA	087753	4 - 6
300L5	3.0HP/460/3	3XSE3044EA	087754	4 - 6
3XSEV1016EA	087835			
3XSEV1006EA	087836			
3XSEV1026EA	087837			
3XSEV1066EA	087838			
3XSEV1036EA	087839			
3XSEV1046EA	087840			
3XSEV1506EA	087841			
3XSEV1526EA	087842			
3XSEV1566EA	087843			
3XSEV1536EA	087844			
3XSEV1546EA	087845			
3XSEV2006EA	087846			
3XSEV2026EA	087847			
3XSEV2066EA	087848			
3XSEV2036EA	087849			
3XSEV2046EA	087850			
3XSEV2004EA	087768			
3XSEV2024EA	087769			
3XSEV2064EA	087770			
3XSEV2034EA	087771			
3XSEV2044EA	087772			
3XSEV3004EA	087822			
3XSEV3024EA	087823			
3XSEV3064EA	087824			
3XSEV3034EA	087825			
3XSEV3044EA	087826			

Previous Models are Discontinued. Consult Factory for current replacement if not shown.



A Crane Co. Company

PUMPS & SYSTEMS

USA: (937) 778-8947 • Canada: (905) 457-6223 • International: (937) 615-3598

SECTION	1C
PAGE	C
DATE	12/04

Cross-Reference Chart

Engineered Pump

BARNES®

www.cranepumps.com

3" Horizontal Discharge XP - Submersible Non-Clog Pumps

*Previous Models		Current Models		
MODEL	P/N	MODEL	P/N	PAGE NO.
3XSEV5004EA	087827			
3XSEV5024EA	087828			
3XSEV5046EA	087829			
3XSEV5034EA	087830			
3XSEV5044EA	087831			
3XSEV7564EA	087832			
3XSEV7534EA	087833			
3XSEV7544EA	087834			

Previous Models are Discontinued. Consult Factory for current replacement if not shown.

SECTION 1C
PAGE D
DATE 12/04

CRANE®

A Crane Co. Company

PUMPS & SYSTEMS

USA: (937) 778-8947 • Canada: (905) 457-6223 • International: (937) 615-3598

3" Horizontal Discharge XP - Submersible Non-Clog Pumps

Specifications:

DISCHARGE	3" NPT, 125 lb. Horizontal
LIQUID TEMPERATURE	104°F (40°C) Continuous
VOLUTE	Cast Iron ASTM A-48, Class 30
MOTOR HOUSING	Cast Iron ASTM A-48, Class 30
SEAL PLATE	Cast Iron ASTM A-48, Class 30
IMPELLER: Design	2 Port, Enclosed, Dynamically Balanced, ISO G6.3
<i>Material</i>	Cast Iron ASTM A-48, Class 30
SHAFT	416 Stainless Steel
SQUARE RINGS	Buna-N
HARDWARE	300 Series Stainless Steel
LIFTING CHAIN	Yoke, Galvanized
PAINT	Air Dry Enamel.
SEAL:	
<i>Design</i>	Tandem Mechanical, Oil Filled Reservoir.
<i>Material</i>	Rotating Faces - Carbon Stationary Faces - Ceramic Elastomer - Buna-N Hardware -300 Series Stainless
CORD ENTRY	25 ft. (7.6m) Std. Cord. Epoxy Sealed Housing with Secondary Pressure Grommet for Sealing and Strain Relief
UPPER BEARING:	
<i>Design</i>	Single Row, Ball, Grease Lubricated
<i>Load</i>	Radial
LOWER BEARING:	
<i>Design</i>	Single Row, Ball, Grease Lubricated
<i>Load</i>	Radial & Thrust
MOTOR: Design	NEMA L - Single Phase, NEMA B - Three Phase Torque Curve. Air-Filled, Squirrel Cage Induction, "UL" Listed for Class I, Groups C & D, Division 1, Explosion Proof
<i>Insulation</i>	Class F.
SINGLE PHASE	Capacitor Start/Induction Run. Start Capacitors Included with Pump Assembly. Controls Require External Overload Protection.
THREE PHASE	Dual Voltage 230/460; Requires Overload Protection to be Included in control panel.
MOISTURE SENSOR	Normally Open (N/O), Requires Relay in Control Panel
TEMPERATURE SENSOR	Normally Closed (N/C), Requires Relay in Control Panel
OPTIONAL EQUIPMENT	Seal Material, Impeller Trims, Cord Length

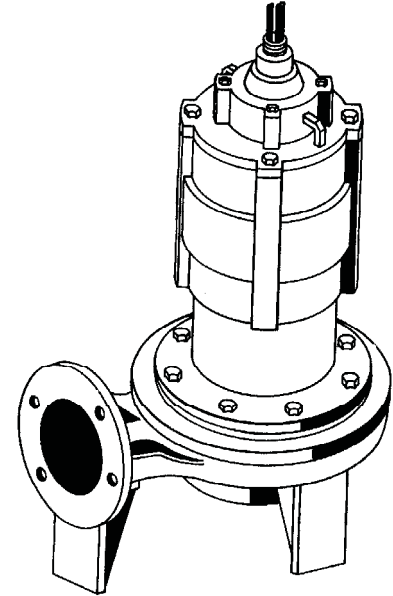

Series: 3XSE-EA
0.75HP, 1150RPM, 60Hz



Canadian Standards Association
File No. LR16567-25



Underwriters Laboratories Inc.®
File No. E73842

Sample Specifications: Section 1 Page 21.

DESCRIPTION:

SUBMERSIBLE NON-CLOG SEWAGE PUMP
DESIGNED FOR **HAZARDOUS** RAW
SEWAGE APPLICATIONS.

Series 3XSE-EA

2" Spherical Solids Handling
Class I, Groups C & D, Division 1

BARNES®

www.cranepumps.com

3" Horizontal Discharge XP - Submersible Non-Clog Pumps

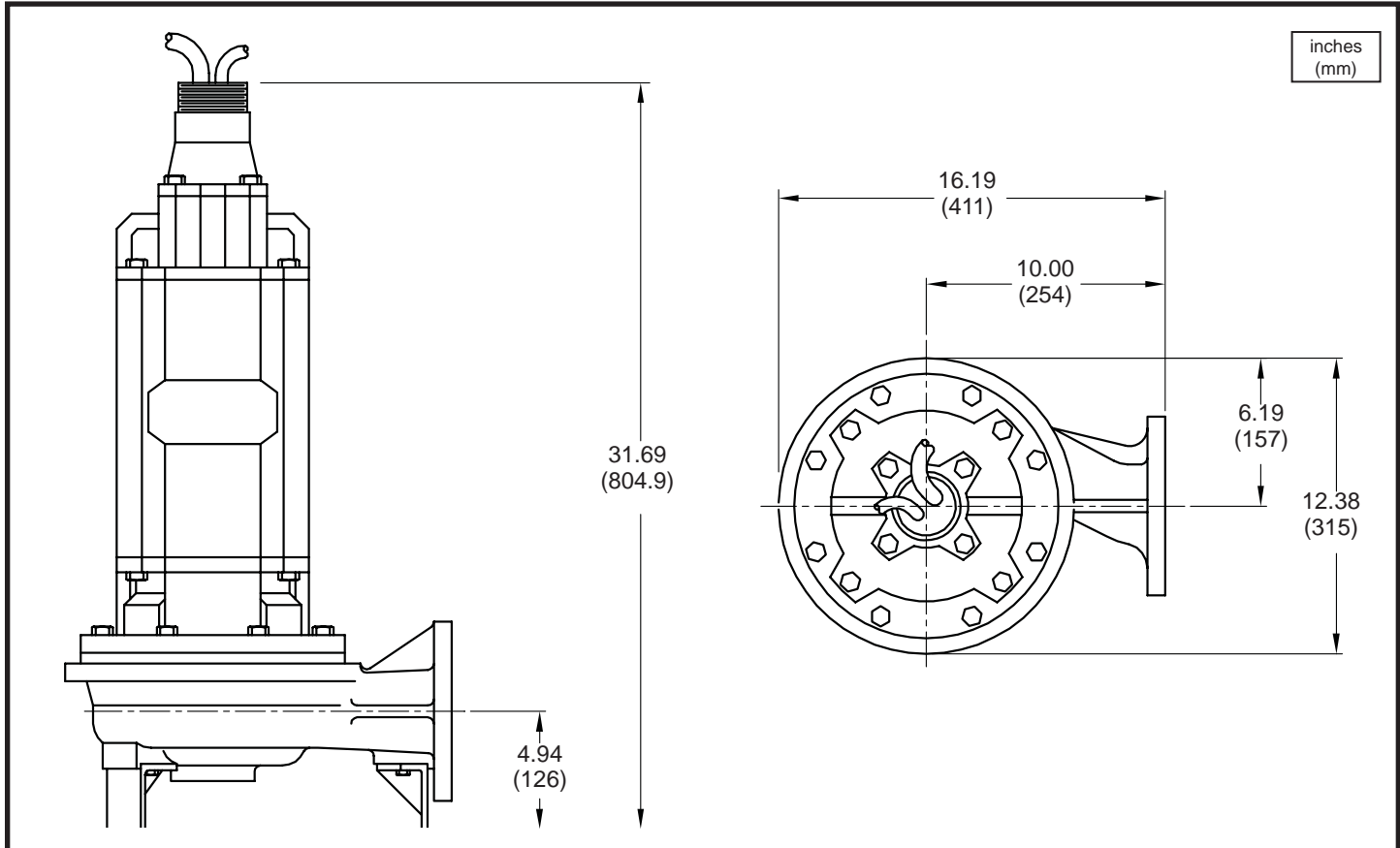

MODEL NO	PART NO	HP	VOLT/Ph	Hz	RPM (Nom)	NEMA START CODE	FULL LOAD AMPS	LOCKED ROTOR AMPS	CORD SIZE	CORD TYPE	CORD O.D. ± .02 (.5) in (mm)
3XSE716EA	087756	.75	115/1	60	1150	K	15.2	52.6	12/4	SOW	0.675 (17)
3XSE706EA	087757	.75	200/1	60	1150	K	8.7	30.2	12/4	SOW	0.675 (17)
3XSE726EA	087758	.75	230/1	60	1150	K	7.6	26.3	12/4	SOW	0.675 (17)
3XSE766EA	087759	.75	200/3	60	1150	L	2.9	15.4	14/4	SOW	0.590 (15)
3XSE736EA	087760	.75	230/3	60	1150	L	2.6	13.4	14/4	SOW	0.590 (15)
3XSE746EA	087761	.75	460/3	60	1150	L	1.3	6.7	14/4	SOW	0.590 (15)

Moisture and Temperature sensor cord for all models is 18/5 SOW, 0.485 (12.4mm) ± .02 (.51mm) O.D.

IMPORTANT !

- 1.) MOISTURE AND TEMPERATURE SENSORS MUST BE CONNECTED TO VALIDATE THE UL LISTING.
- 2.) A **NON-SPARKING** BREAK AWAY FITTING MUST BE USED TO VALIDATE THE UL LISTING.
- 3.) A SPECIAL MOISTURE SENSOR RELAY IS REQUIRED IN THE CONTROL PANEL FOR PROPER OPERATION OF THE MOISTURE SENSORS. CONTACT BARNES PUMPS FOR INFORMATION CONCERNING MOISTURE SENSING RELAYS FOR CUSTOMER SUPPLIED CONTROL PANELS.
- 4.) THESE PUMPS ARE UL LISTED FOR PUMPING WATER AND WASTEWATER. **DO NOT USE TO PUMP FLAMMABLE LIQUIDS.**
- 5.) INSTALLATIONS SUCH AS DECORATIVE FOUNTAINS OR WATER FEATURES PROVIDED FOR VISUAL ENJOYMENT MUST BE INSTALLED IN ACCORDANCE WITH THE NATIONAL ELECTRIC CODE ANSI/NFPA 70 AND/OR THE AUTHORITY HAVING JURISDICTION. THIS PUMP IS NOT INTENDED FOR USE IN SWIMMING POOLS, RECREATIONAL WATER PARKS, OR INSTALLATIONS IN WHICH HUMAN CONTACT WITH PUMPED MEDIA IS A COMMON OCCURRENCE.

SECTION 1C
PAGE 2
DATE 2/07

CRANE
®

A Crane Co. Company

PUMPS & SYSTEMS

USA: (937) 778-8947 • Canada: (905) 457-6223 • International: (937) 615-3598

3" Horizontal Discharge XP - Submersible Non-Clog Pumps

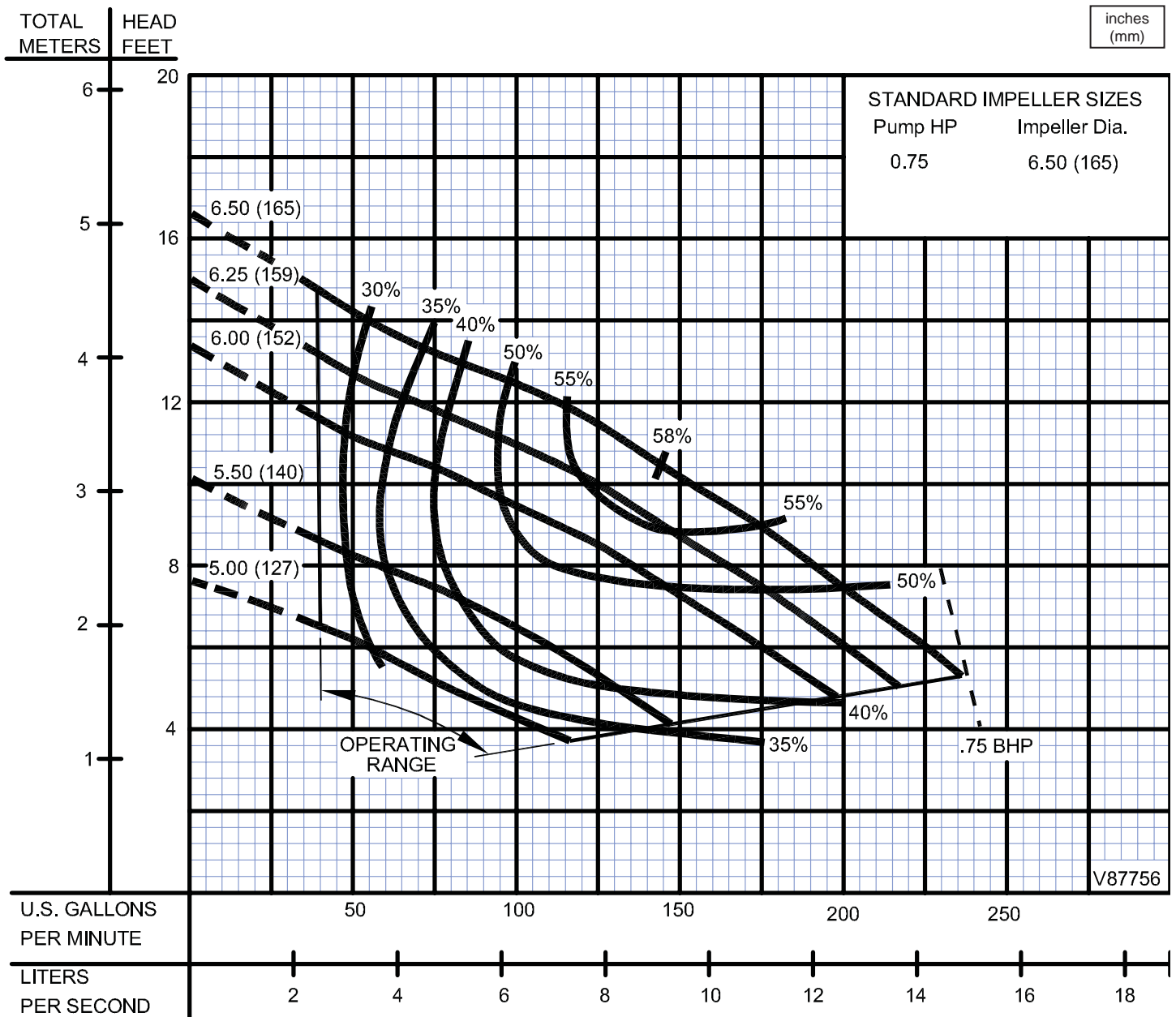

Testing is performed with water, specific gravity 1.0 @ 68° F @ (20°C), other fluids may vary performance

Series 3XSE-EA

2" Spherical Solids Handling
Class I, Groups C & D, Division 1



www.cranepumps.com

3" Horizontal Discharge XP - Submersible Non-Clog Pumps

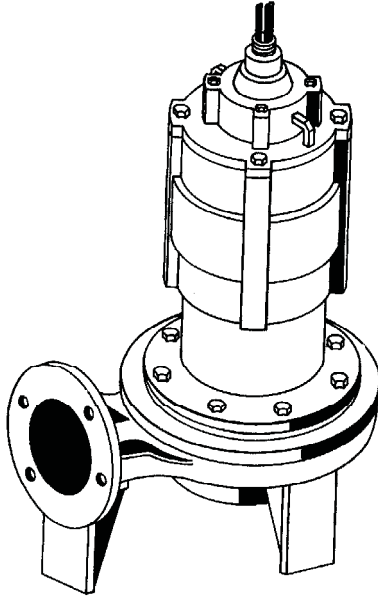

Series: 3XSE-EA
1.5, 2.0 & 3.0 HP,
1750RPM, 60Hz



Canadian Standards Association
File No. LR16567-25



Underwriters Laboratories Inc
File No. E73842

Sample Specifications: Section 1 Page 21.

DESCRIPTION:

SUBMERSIBLE NON-CLOG SEWAGE PUMP
DESIGNED FOR **HAZARDOUS** RAW
SEWAGE APPLICATIONS.

Specifications:

DISCHARGE	3" NPT, 125 lb. Horizontal
LIQUID TEMPERATURE	104°F (40°C) Continuous
VOLUTE	Cast Iron ASTM A-48, Class 30
MOTOR HOUSING	Cast Iron ASTM A-48, Class 30
SEAL PLATE	Cast Iron ASTM A-48, Class 30
IMPELLER: Design	2 Port, Enclosed, Dynamically Balanced, ISO G6.3
<i>Material</i>	Cast Iron ASTM A-48, Class 30
SHAFT	416 Stainless Steel
SQUARE RINGS	Buna-N
HARDWARE	300 Series Stainless Steel
LIFTING CHAIN	Yoke, Galvanized
PAINT	Air Dry Enamel
SEAL: Design	Tandem Mechanical, Oil Filled Reservoir.
<i>Material</i>	Rotating Faces - Carbon Stationary Faces - Ceramic Elastomer - Buna-N Hardware -300 Series Stainless
CORD ENTRY	25 ft. (7.6m) Std. Cord. Epoxy Sealed Housing with Secondary Pressure Grommet for Sealing and Strain Relief
UPPER BEARING:	
<i>Design</i>	Single Row, Ball, Grease Lubricated
<i>Load</i>	Radial
LOWER BEARING:	
<i>Design</i>	Single, Ball, Grease Lubricated
<i>Load</i>	Radial & Thrust
MOTOR: Design	NEMA L - Single Phase, NEMA B - Three Phase Torque Curve. Air-Filled, Squirrel Cage Induction, "UL" Listed for Class I, Groups C & D, Division 1, Explosion Proof
<i>Insulation</i>	Class F.
SINGLE PHASE	Capacitor Start/Induction Run. Start Capacitors Included with Pump Assembly. Controls Require External Overload Protection.
THREE PHASE	Dual Voltage 230/460; Requires Overload Protection to be Included in control panel.
MOISTURE SENSOR	Normally Open (N/O), Requires Relay in Control Panel
TEMPERATURE SENSOR	Normally Closed (N/C), Requires Relay in Control Panel
OPTIONAL EQUIPMENT	Seal Material, Impeller Trims, Cord Length

SECTION 1C
PAGE 4
DATE 2/07



A Crane Co. Company

PUMPS & SYSTEMS

USA: (937) 778-8947 • Canada: (905) 457-6223 • International: (937) 615-3598

3" Horizontal Discharge XP - Submersible Non-Clog Pumps

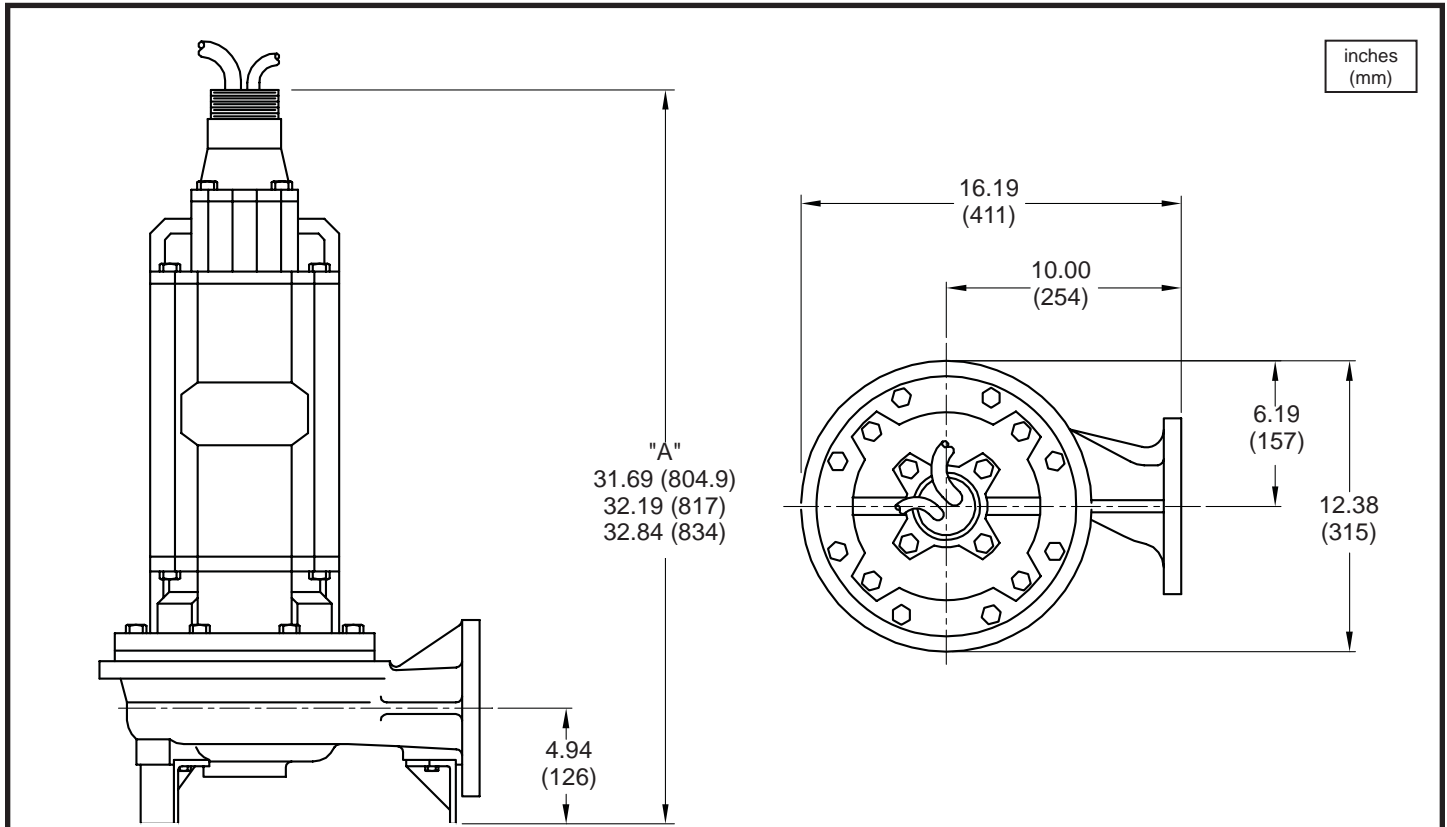

MODEL NO	PART NO	"A" DIM	HP	VOLT/Ph	Hz	RPM (Nom)	NEMA START CODE	FULL LOAD AMPS	LOCKED ROTOR AMPS	CORD SIZE	CORD TYPE	CORD O.D. ± .02 (.5) in (mm)
3XSE1504EA	087740	31.19	1.5	200/1	60	1750	K	13.2	66.7	14/4	SOW	0.590 (15)
3XSE1524EA	087741	31.19	1.5	230/1	60	1750	K	11.5	58.0	14/4	SOW	0.590 (15)
3XSE1564EA	087742	31.19	1.5	200/3	60	1750	K	6.9	34.9	14/4	SOW	0.590 (15)
3XSE1534EA	087743	31.19	1.5	230/3	60	1750	K	6.0	30.4	14/4	SOW	0.590 (15)
3XSE1544EA	087744	31.19	1.5	460/3	60	1750	K	3.0	15.2	14/4	SOW	0.590 (15)
3XSE2004EA	087745	31.69	2.0	200/1	60	1750	J	16.1	79.3	12/4	SOW	0.675 (17)
3XSE2024EA	087746	31.69	2.0	230/1	60	1750	K	14.0	69.0	12/4	SOW	0.675 (17)
3XSE2064EA	087747	31.19	2.0	200/3	60	1750	K	8.2	50.3	14/4	SOW	0.590 (15)
3XSE2034EA	087748	31.19	2.0	230/3	60	1750	K	7.2	43.8	14/4	SOW	0.590 (15)
3XSE2044EA	087749	31.19	2.0	460/3	60	1750	K	3.6	21.9	14/4	SOW	0.590 (15)
3XSE3004EA	087750	32.34	3.0	200/1	60	1750	J	23.0	111.5	10/4	SOW	0.735 (19)
3XSE3024EA	087751	32.34	3.0	230/1	60	1750	J	20.0	97.0	10/4	SOW	0.735 (19)
3XSE3064EA	087752	31.19	3.0	200/3	60	1750	H	11.9	58.9	14/4	SOW	0.590 (15)
3XSE3034EA	087753	31.19	3.0	230/3	60	1750	H	10.4	51.3	14/4	SOW	0.590 (15)
3XSE3044EA	087754	31.19	3.0	460/3	60	1750	H	5.2	25.6	14/4	SOW	0.590 (15)

Moisture and Temperature sensor cord for all models is 18/5 SOW, 0.485 (12.4mm) ± .02 (.51mm) O.D.

IMPORTANT !

- 1.) MOISTURE AND TEMPERATURE SENSORS MUST BE CONNECTED TO VALIDATE THE UL LISTING.
- 2.) A **NON-SPARKING** BREAK AWAY FITTING MUST BE USED TO VALIDATE THE UL LISTING.
- 3.) A SPECIAL MOISTURE SENSOR RELAY IS REQUIRED IN THE CONTROL PANEL FOR PROPER OPERATION OF THE MOISTURE SENSORS. CONTACT BARNES PUMPS FOR INFORMATION CONCERNING MOISTURE SENSING RELAYS FOR CUSTOMER SUPPLIED CONTROL PANELS.
- 4.) THESE PUMPS ARE UL LISTED FOR PUMPING WATER AND WASTEWATER. **DO NOT USE TO PUMP FLAMMABLE LIQUIDS.**
- 5.) INSTALLATIONS SUCH AS DECORATIVE FOUNTAINS OR WATER FEATURES PROVIDED FOR VISUAL ENJOYMENT MUST BE INSTALLED IN ACCORDANCE WITH THE NATIONAL ELECTRIC CODE ANSI/NFPA 70 AND/OR THE AUTHORITY HAVING JURISDICTION. THIS PUMP IS NOT INTENDED FOR USE IN SWIMMING POOLS, RECREATIONAL WATER PARKS, OR INSTALLATIONS IN WHICH HUMAN CONTACT WITH PUMPED MEDIA IS A COMMON OCCURRENCE.

Series 3XSE-EA

Performance Curve - Class I, Groups C & D, Division 1
1.5, 2.0 & 3.0HP, 1750RPM, 60Hz

BARNES®

www.cranepumps.com

3" Horizontal Discharge XP - Submersible Non-Clog Pumps

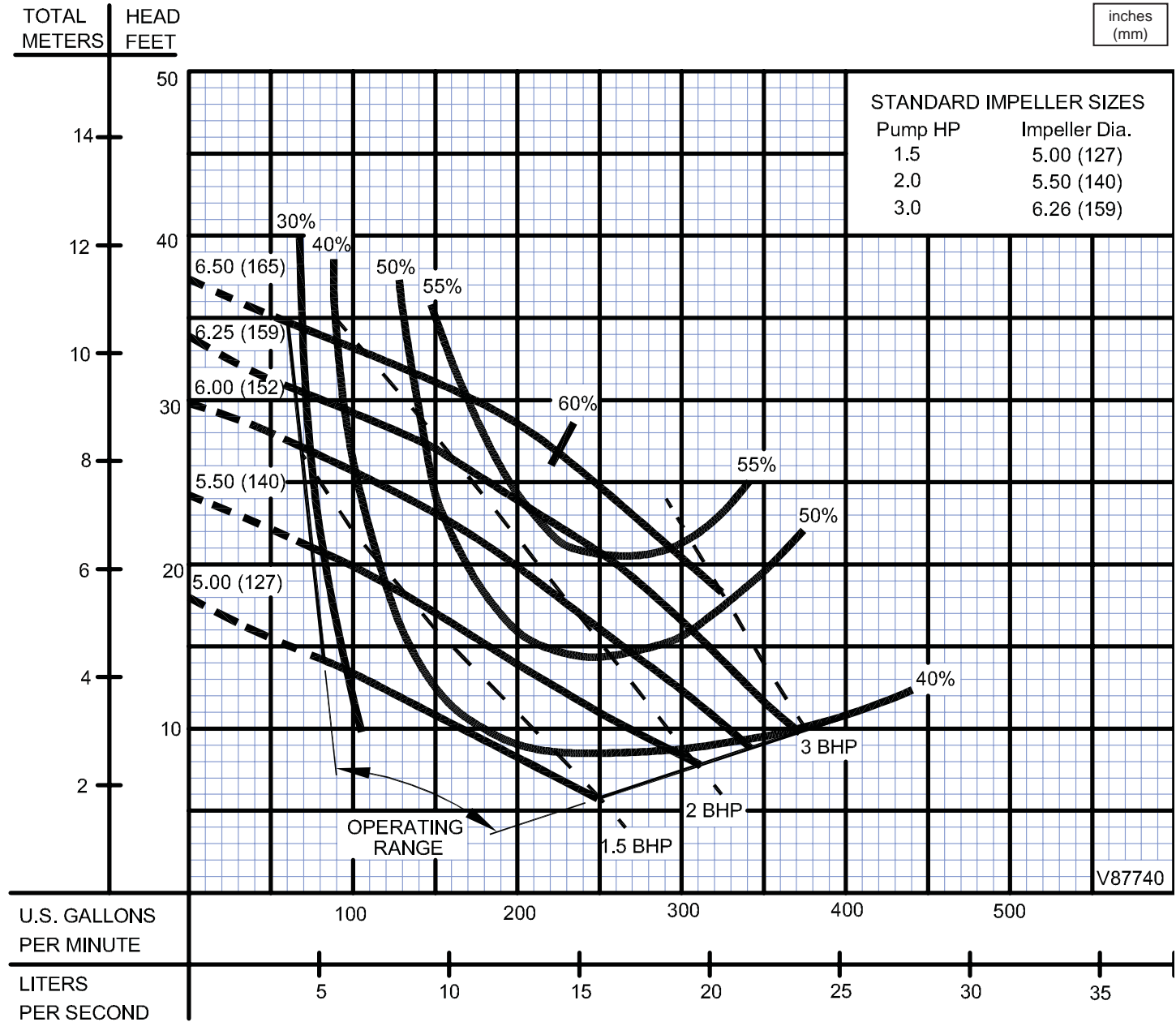

Testing is performed with water, specific gravity 1.0 @ 68° F @ (20°C), other fluids may vary performance

SECTION 1C
PAGE 6
DATE 6/05

CRANE
A Crane Co. Company

PUMPS & SYSTEMS

USA: (937) 778-8947 • Canada: (905) 457-6223 • International: (937) 615-3598